

DESIGN LOAD REPORT

Part Description: P1386 Beam Clamps 12 Ga. Channel
Report Date: January 21, 2009

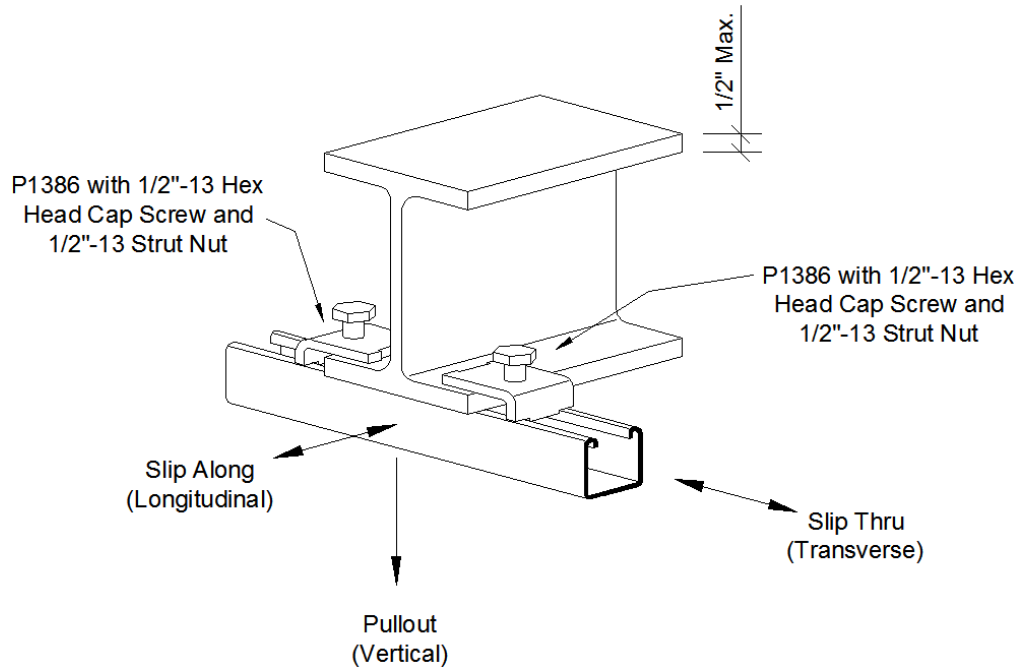

Average Ultimate Load (lbs)			Design Load (lbs)		
Pullout	Slip Along	Slip Thru	Pullout	Slip Along	Slip Thru
11,060	1,410	3,080	1,200	200	600

NOTES

1. Ultimate Loads From Test Reports, C-103, C-104 & C-249
2. Average Minimum Safety Factor of 5
3. Design Loads are for a 2 Clamp Installation
4. Must Use Clamps in Pairs

Unistrut Engineering